

# Manual of code Lock

## 1. Code set-up

( Please strictly follow below steps to avoid self - lock ! )

- ① Enter the code 0-0-0 aligned with the baseline visible on 1 side of the lock. Insert a thin sharp object and press the hidden silver button below the code
- ② Push the silver button to the end and remove the sharp object from the button.
- ③ Now you can set your personal code combination by aligning the code with the baseline.
- ④ Finish the set-up of your code by pushing the silver button back in on the reverse side of the lock. This can be done with your finger.

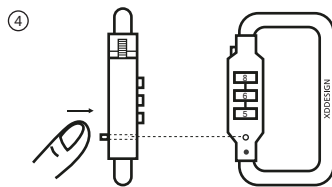
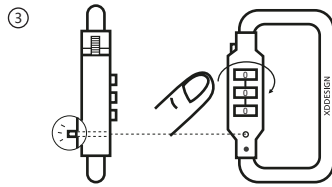
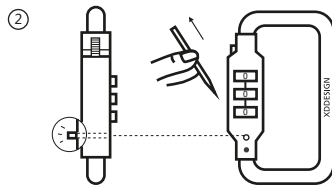
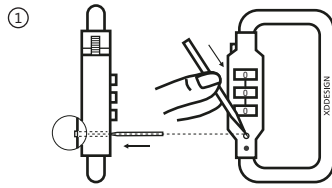

## 2. Open code lock

Press the small black side button downwards with your fingertip and pull the lock outwards to open.

